

# INSTRUCTIONS

## NICHOLAS ILLUMINATOR

**BAUSCH & LOMB** 

## The Nicholas Illuminator -

Cat. Nos. 31-33-05-01

31-33-05-02

31-33-05-03

31-33-05-04

The Nicholas Illuminator provides a highly directional spotlight illumination and brings out shadows of surface contours. This Illuminator is recommended for opaque-diffuse, transparent or translucent specimens. The unit may be mounted to the StereoZoom or StereoZoom 7 power pod, to the arm of the A Stand (Cat. No. 31-26-88), to the Stationary Arm (Cat. No. 31-26-59), to the B Base (Cat. No. 31-26-84), or to the Transformer base. Consult the instruction books for the StereoZoom microscopes for additional data.

### Mounting

To mount the Illuminator to the A Stand, the Stationary Arm or the B Base:

1. Insert the Illuminator into the circular opening in the Arm or Base and plug the Illuminator Cord into the rear of the Transformer.
2. Plug the Transformer Cord into an electrical outlet and turn the Transformer Knob for the desired illumination level. If mounted to the B Base, rotate the substage mirror for the best illumination.

To mount the Illuminator to the Power Pod:

1. Attach the Swivel end of the Linkage to one of the illumina-

tor stations on the power pod and tighten the thumbscrew.

2. Remove the tape from the other end of the Linkage. Be sure the lock washer remains in place.
3. Insert the Nicholas Illuminator into the Adapter and plug the Illuminator Cord into the Transformer base outlet.
4. Plug the Transformer Cord into an electrical outlet. Turn the Transformer Knob for the best illumination level and position the Illuminator as desired.

**HELPFUL HINT:** Operating the lamp on tap 2 of the Transformer will result in many extra hours of lamp life.

### Lamp Replacement

1. Unplug the Transformer Cord. Loosen each of the two clamp screws one complete turn. Rotate the Lamp Housing until it can be pulled off over the screw heads.
2. Twist the lamp counterclockwise, at the same time applying a slight tilting action, and remove.
3. Align the notch in the new lamp's circular base plate with the notch in the triangular Lamp Housing plate. Seat the lamp on the retaining pins and twist it clockwise using a slight tilting action to raise the pins until it locks in place.
4. Wipe off the lamp and reassemble the Illuminator.

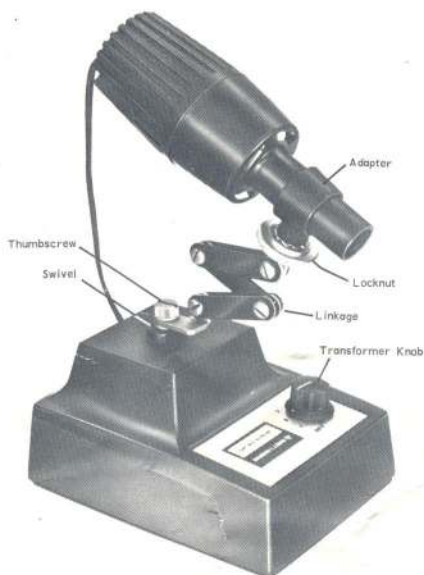

THE NICHOLAS ILLUMINATOR

### Available Equipment

<u>Cat. No.</u>	<u>Description</u>
31-33-05-01	Nicholas Illuminator, Transformer (3 Tap, 6V, 2-wire), Adapter, Linkage
31-33-05-02	Nicholas Illuminator, Transformer (1 Tap, 6V, 2-wire), Adapter, Linkage
31-33-05-03	Nicholas Illuminator, Transformer (3 Tap, 240/6V, 3-wire), Adapter, Linkage
31-33-05-04	Nicholas Illuminator, Transformer (3 Tap, 120/6V, 3-wire), Adapter, Linkage
31-33-05	Nicholas Illuminator
31-35-30	Transformer (3 Tap, 6V, 2-wire)
31-35-31	Transformer (1 Tap, 6V, 2-wire)
31-35-38	Transformer (3 Tap, 240/6V, 3-wire)
31-35-47	Transformer (3 Tap, 120/6V, 3-wire)
31-35-34	Adapter
31-35-41	Linkage
31-31-76	Lamp (Box of 5)
31-31-75	Lamp (Pkg. of 1)

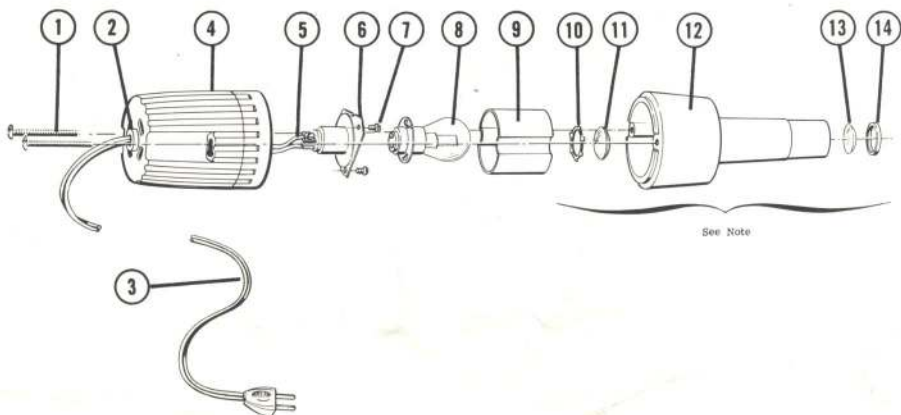

NICHOLAS ILLUMINATOR (EXPLODED VIEW)

### Parts List - Nicholas Illuminator

<u>Description</u>	<u>Part No.</u>
1. Screw (2 required)	313305-102ND
2. Strain Relief	313305-103ND
3. Cord Set	313353-180ND
4. Cover	313305-101
5. Sleeve (2 required)	313353-178
6. Lamp Holder	313353-136ND
7. 4 - 40 x 5/16 Screw (3 required)	313305-104ND
8. GE #1460X Lamp	313175-101
9. Shield	313353-148
10. Lens Retainer	313353-197
11. Lens A	313353-024
12. Lens B	313353-022
13. Retainer	313353-199
14. Lens Mount Assy.	313305-105
	} 313305-910ND

NOTE: Parts numbered 10 thru 14 are factory assembled by special tools. The assembled unit may be ordered complete by Part No. 313305-910ND -Lens & Mount Ass'y.